

Halton Safe HSD – Smoke sensor, duct



Overview

Halton Safe HSD is part of the Halton fire and smoke safety offering.

This is an optical sensor and detects smoke in ventilation ducts. It is used to provide alarm indication to Halton Safe HSL link units. The sensor type is Calectro UG-3-O. The sensor consists of a smoke detector, mounted in an adapter system where both the tube and housing are designed for optimum airflow through the smoke detector. The sensor fulfils the requirements for fire detection with air velocities from 0.2 to 20 m/s.

Note: An optical sensor reacts to the consistency of particles in the air, for example, smoke. It can react also to dense water vapour.

Applications

- Controlling fire dampers and smoke detectors in buildings

Key features

- Optical smoke sensor
- Easy to install

Features and options

Feature	Description
Power supply	24 V DC
Detector type	Optical
Communication	mA current
IP class	IP54

Dimensions and weight

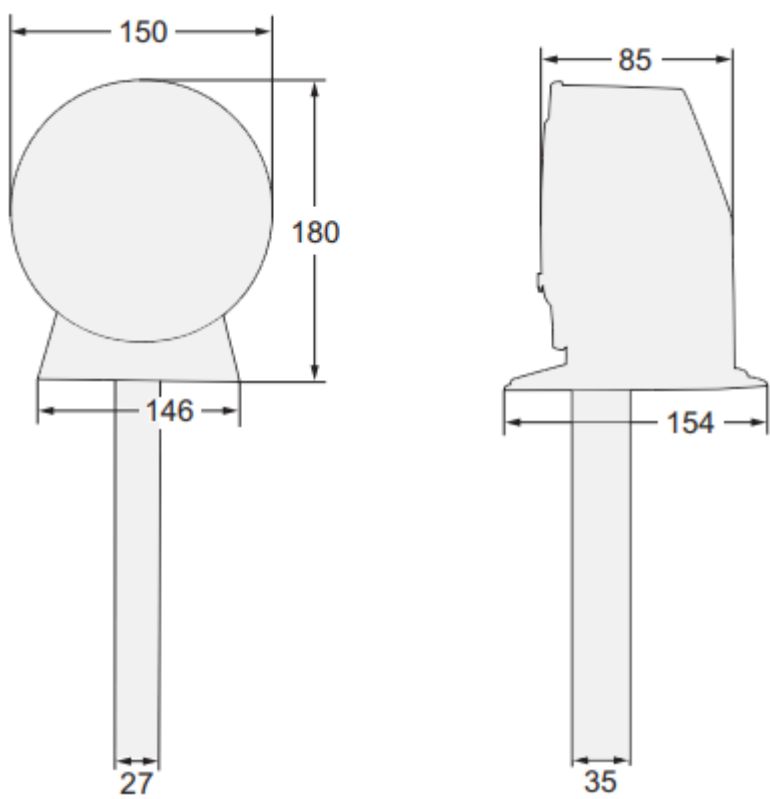

Fig.1. Dimensions of Halton Safe HSD

Weight:

0.66 kg

Specification

Optical smoke detector in duct for Halton Safe Management 2.0 system.

Installation information

For detailed information as well as installation and maintenance instructions, see the Calectro website.

Connection diagram

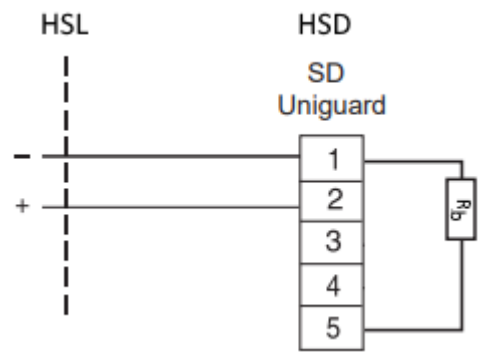

Fig.2. Connection diagram of Halton Safe HSD. Rb: Terminating resistor 2.2 kΩ.

Order code

HSD/M; ZT

M = Model
DI Calectro UG-3-0

Other options and accessories

ZT = Tailored product
N No

Code example

HSD/DI, ZT=N